

5 Turning on the TV

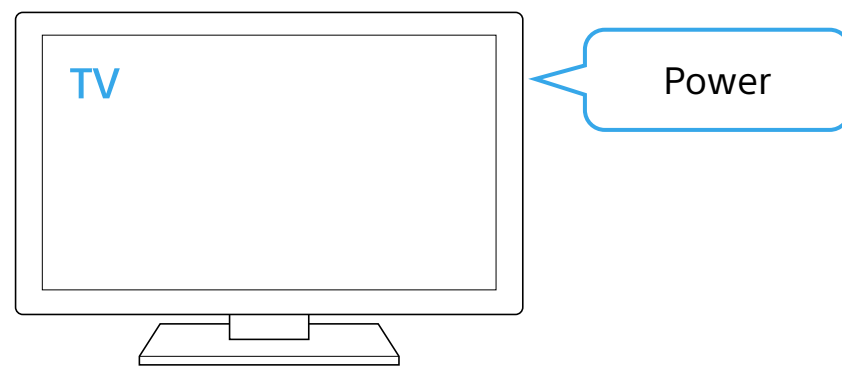

6 Turning on the system

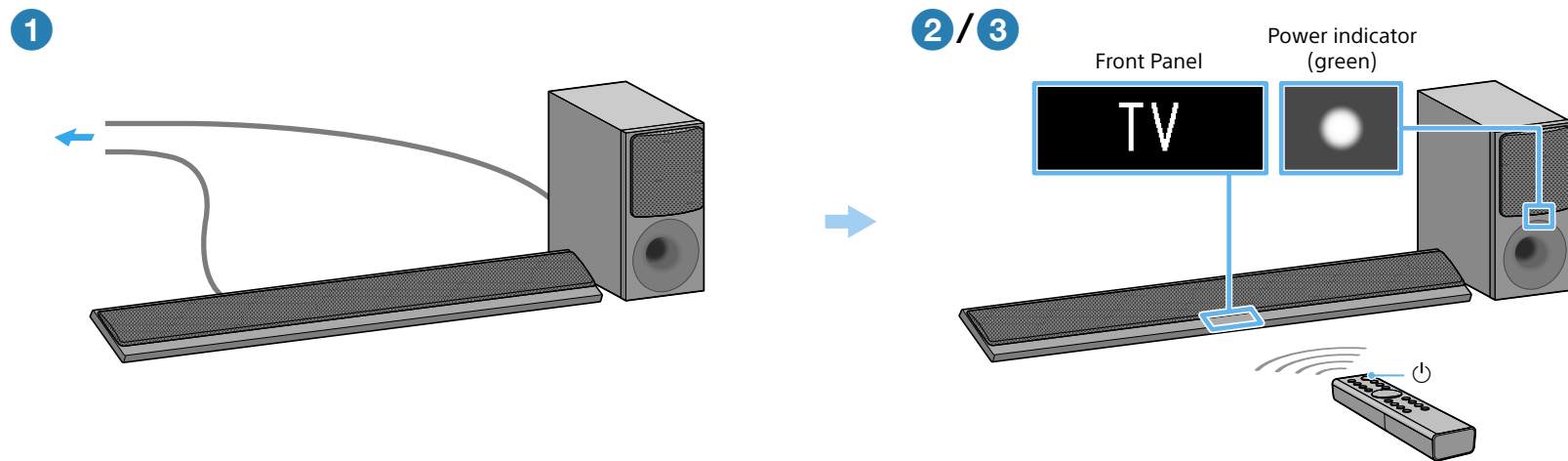

- 1 Connect the AC power cords (mains leads) of the Bar Speaker and subwoofer.
- 2 Press (power) of the remote control.
The front panel display lights up.
- 3 Confirm that the power indicator of the subwoofer is lit in green.
If not, refer to "Subwoofer" of "Troubleshooting" in the Operating Instructions (separate document).
- 4 Turn on the connected device.

Tip

- For details on the settings of the control for HDMI on the TV, refer to the Operating Instructions supplied with the TV.

7 Performing Easy Setup

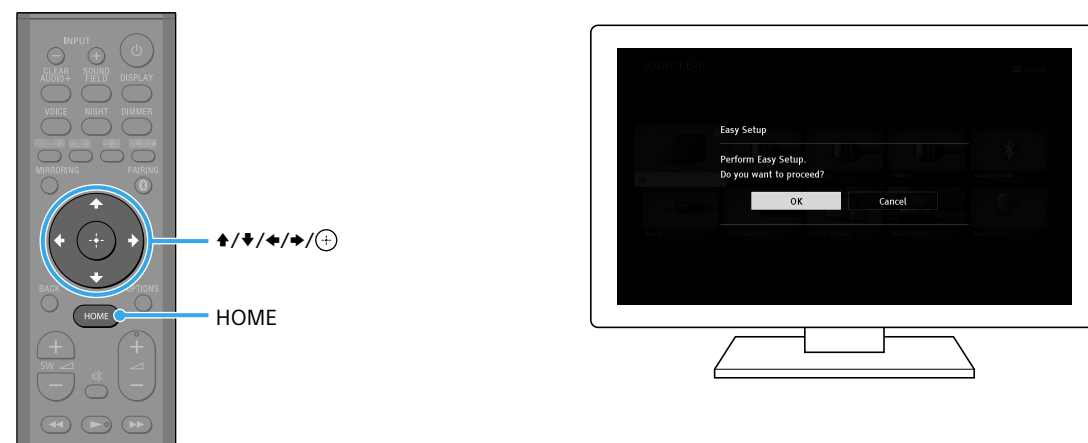

- 1 Press HOME on the remote control of this system.
The Easy Setup screen is displayed on the TV screen.
If the Easy Setup screen does not appear, use the remote control of the TV to switch the TV input setting to the HDMI input jack that connects the TV to the system.
- 2 Press to select an item as instructed on the TV screen, and then press to perform Easy Setup.
- 3 Once [Easy Initial Settings are complete.] appears, select [Finish].

Tip

- On-screen instructions are displayed in the language you selected in this step.
- For details on the network connection, refer to "Enjoying with the Network Function" in the Operating Instructions (separate document).

8 Listening to the sound

